



ACE PNEUMATICS PVT. LTD.

ACE RD658 5L ROCK DRILL

PARTS LIST

POWER TECHNOLOGY TRUST

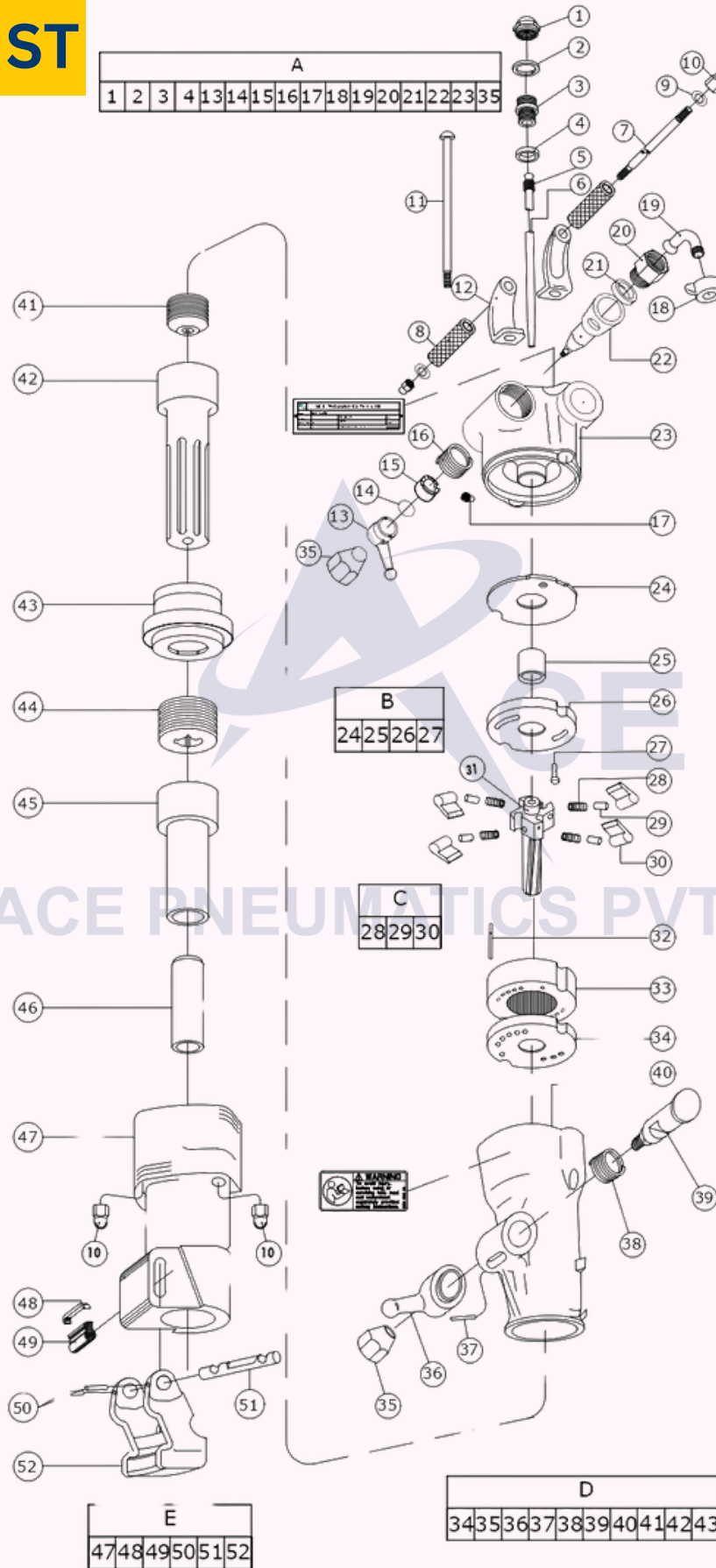

ACE PNEUMATICS PVT. LTD.

ACE RD658 5I ROCK DRILL

SR. No.	PART NO.	OEM PART NO.	DESCRIPTION	QTY/TOOL
1	251010	3100 9643 01	Protective Nut	1
2	251015	3101 4146 00	Seal Washer - Large	1
3	251020	3100 9623 01	Adopter	1
4	251025	3000 9341 02	Seal Washer - Small	1
5	251030	3121 0336 00	Rubber Packing	1
6	251035	3121 0352 00	Air Tube	1
7	251040	3121 0360 00	Handle Bolt	1
8	251045	3101 1372 00	Rubber Grip Set	3
9	251050	3115 0574 00	Washer	2
10	251055	3121 0292 00	Dome Nut	4
11	251060	3121 0343 00	Side Bolt	2
12	251065	-	Bracket Set (LH & RH.)	2
13	251070	3115 0573 00	Lever Handle Top	1
14	251075	0663 2128 00	O-Ring	1
15	251080	3121 0332 00	Lock Washer	1
16	251085	3121 5000 51	Throttle Valve Spring	1
17	251090	3121 0329 00	Throttle Pin	1
18	251095	9000 0333 00	Wing Nut	1
19	251100	3115 1170 00	Air Bend Pipe	1
20	251105	9000 0345 00	Adapter	1
21	251110	3115 1045 00	Washer	1
22	251115	3121 0349 00	Throttle valve	1
23	251120	3115 0569 00	Backhead	1
24	252010	3106 8681 00	Main Valve	1
25	252015	3100 9894 01	Bush for Cover	1
26	252020	-	Valve Cover	1
27	252025	3100 9665 00	Guide pin	1
28	253010	3100 9140 02	Pawl Spring	4
29	253015	3100 9641 01	Pawl Pin	4
30	253020	3101 3159 00	Pawl	4
31	253025	3101 3154 00	Rifle Bar	1
32	253030	0108 1336 00	Pin - Ratchet Ring	1
33	253035	3106 8682 00	Ratchet Ring	1
34	254010	3106 8683 00	Guide Disc	1
35	254015	3006 8734 00	Conical Nut	1
36	254020	3115 0577 00	Lever Outlet Valve	1
37	254025	0108 3330 00	Elastic Pin	1
38	254030	3121 0338 00	Spring - Outlet Valve	1
39	254035	3115 1778 00	Outlet valve	1
40	254040	3121 0337 00	Cylinder	1
41	254045	3100 9299 05	Rifle Nut	1
42	254050	-	Piston	1
43	254055	3121 0339 00	Intermediate Part	1
44	254060	3115 1221 00	Chuck Nut	1
45	254065	-	Rotation Chuck	1
46	254047	3121 0023 00	Chuck Bushing	1
47	255010	3121 0342 00	Fronthead	1
48	255015	3121 0029 00	Buffer Plate	1
49	255020	3121 0030 00	Rubber Buffer	1
50	255025	0108 3392 00	Tension Pin	2
51	255030	3121 0852 00	Retainer Pin	1
52	255035	3121 0851 00	Retainer	1
A (10-11)	255040	-	Side Bolt Set 2 side Bolt 2 Dome Nut	
B (1 to 5, 13 to 17, 20 to 23, 35)	255045	-	Backhead Complete	
C (24-26)	255050	3106 8680 80	Cover Complete	
D (28-30)	255055	3115 9200 90	Pawl Complete (4 NOS. Each)	
E (35-40)	255060	-	Cylinder Assembly	
F (34-43)	255065	-	Cylinder Complete	
G (41-42)	255070	3100 8478 80	Piston Complete	
H (44-46)	255075	3121 0769 80	Rotation Chuck Complete	
I (47-52)	255080	-	Fronthead Complete	
J (48,49,51 (1 nos) & 50 (2 nos)	255085	-	Retainer Pin Set	

Rivet Buster



Pick Hammer



Jackleg Drill



Sinker Drill



Paving Breaker

